

22 Gloucester Street, Bristol, BS8 4JF

www.hydes.co.uk



22 Gloucester Street, Bristol, BS8 4JF

A well presented one bedroom apartment situated in the heart of Clifton Village close to a wide variety of shops, boutiques and restaurants. This light and airy flat forms one of fourteen apartments constructed in 2009 to a very high standard.

Situated on the second floor this contemporary style apartment has a custom designed Linear Pepper kitchen which includes integrated fridge/freezer, dishwasher and ceramic hob. The fully tiled bathroom has Italian designed Pozzi Ginori sanitary ware with Hansgrove chrome fittings. A utility/linen cupboard within the entrance hall has built in plumbing for a washer/dryer.

A communal entrance and stairway on Gloucester Street leads to an open courtyard to the rear of the building which in turn provides access to all the apartments in the development. There is provision for bicycles and refuse storage off the communal entrance.



1



1



1

Approx. Gross Internal Area
441.0 Sq.Ft - 41.0 Sq.M

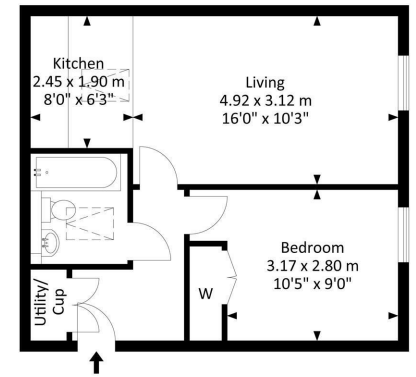

For illustrative purposes only. Not to scale.
Whilst every attempt has been made to ensure
accuracy of the floor plan all measurements are
approximate and no responsibility is taken for
any error, omission or measurement.

